

DAVID WILSON'S TRAILERS Ltd
Putting your information on the road

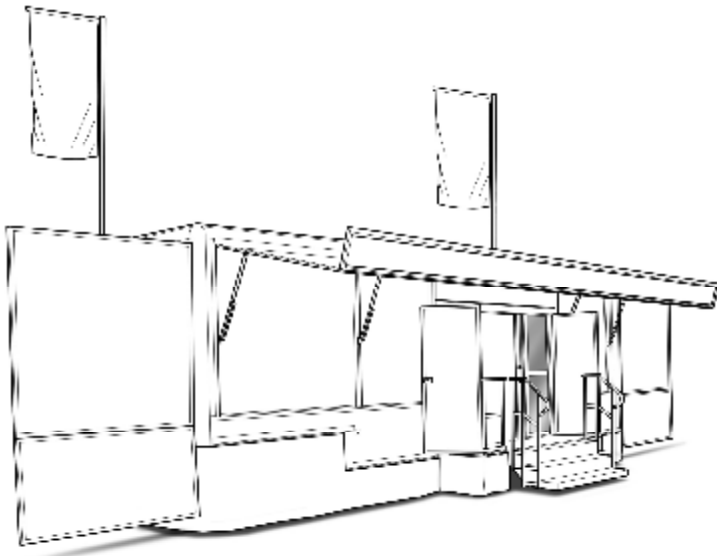

DWT H55- 9m Hospitality Trailer

For Personal Service



tel: **+44 (0)1476 860833**
www.dwt-exhibitions.co.uk

DWT is a leading UK provider of mobile exhibition and outdoor event solutions
Based just off the A1 near Colsterworth in Lincolnshire - in the strategic heart of Britain - our operating centre enables us to deliver and set up exhibition trailers in a single day



DWT H55- 9m Hospitality Trailer



DWT H55 This trailer is designed with a wide and welcoming entrance with bi-fold doors and sliding glazed panels. Internally the trailer expands with a large pod directly opposite the entrance providing a versatile hospitality facility. The large seating area is divided by a small counter ideal for AV presentation display. There is also a separate seating area for six with removable table in the neck area partitioned off by a glazed sliding door. To the rear is a compact galley including sink, fridge, storage and personnel door. The exterior has large area for graphics including swing round and recessed panels, a full length lift up header board and flags to the offside.

DWT H55- 9m Hospitality Trailer



Exterior includes :

- Hinge down entrance platform with clip on steps and handrails.
- Bi-fold graphic panels covered in Blue Nyloop panels.
- Front and rear swing round and drop down graphic panels.
- Glazed entrance with lockable glazed sliding doors.
- Full length rigid canopy with lift up header board.
- Extensive graphic panel area.
- Large slide out pod to offside with daylight canopy.
- Small slide out pod for seating to offside front neck.
- 2 off 20ft Flagpoles fitted to the offside.
- 240v mains inlet power supply with extension cable.
- Blue PVC skirting.

Interior includes :

- Seating for up to 16 with storage space beneath.
- Display cupboard
- Literature rack and cupboard either side of entrance
- Compact Galley, with fridge, sink and storage cupboards
- Large slide out extension pod with hospitality seating and storage space
- Extensive Nyloop graphic panels in blue
- Recessed spot lighting
- Separate office area to the front with seating for six, table and sliding door
- 6 off Double sockets located throughout



DWT H55- 9m Hospitality Trailer

Layout Plan

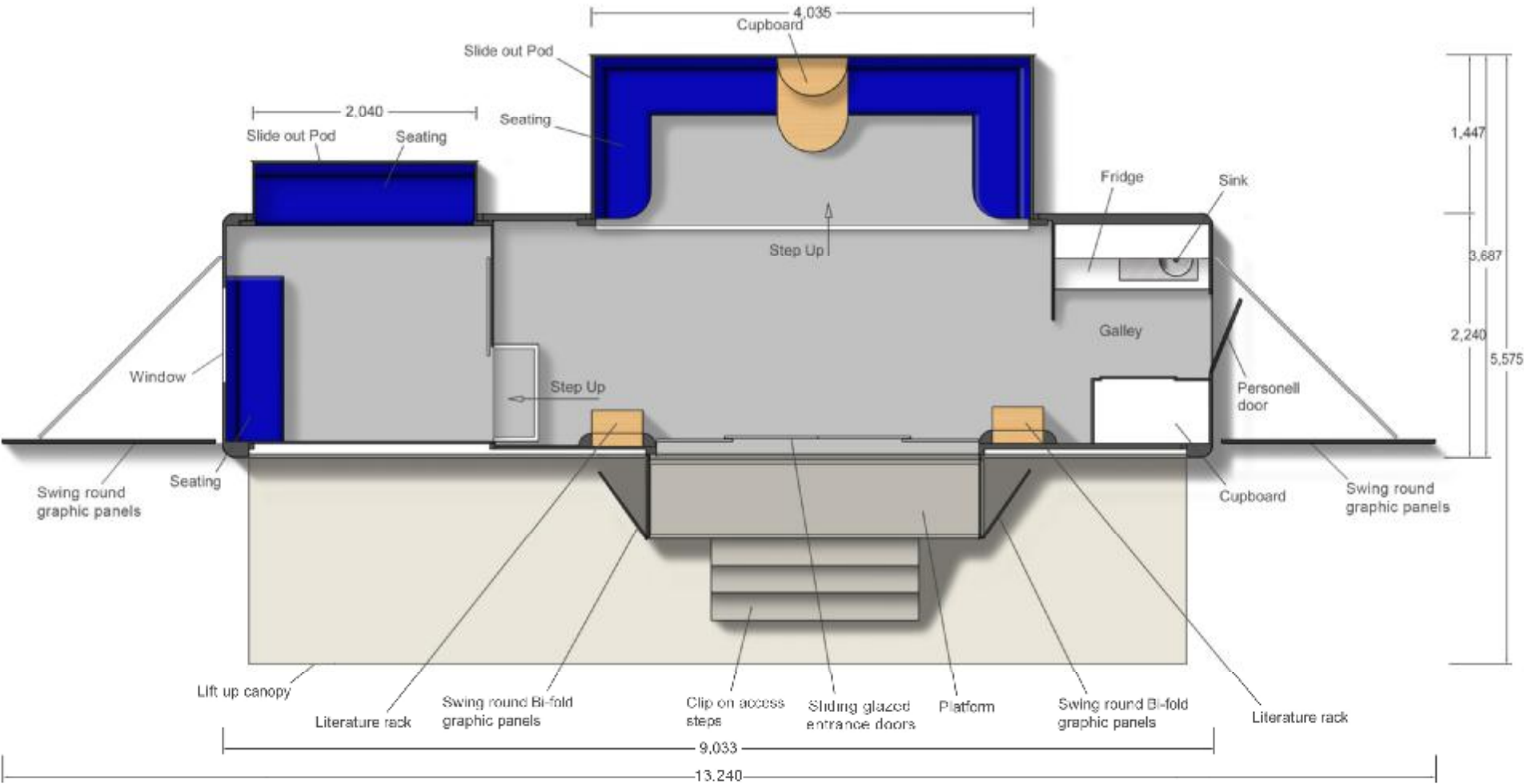

DWT H55- 9m Hospitality Trailer

Electrical Plan

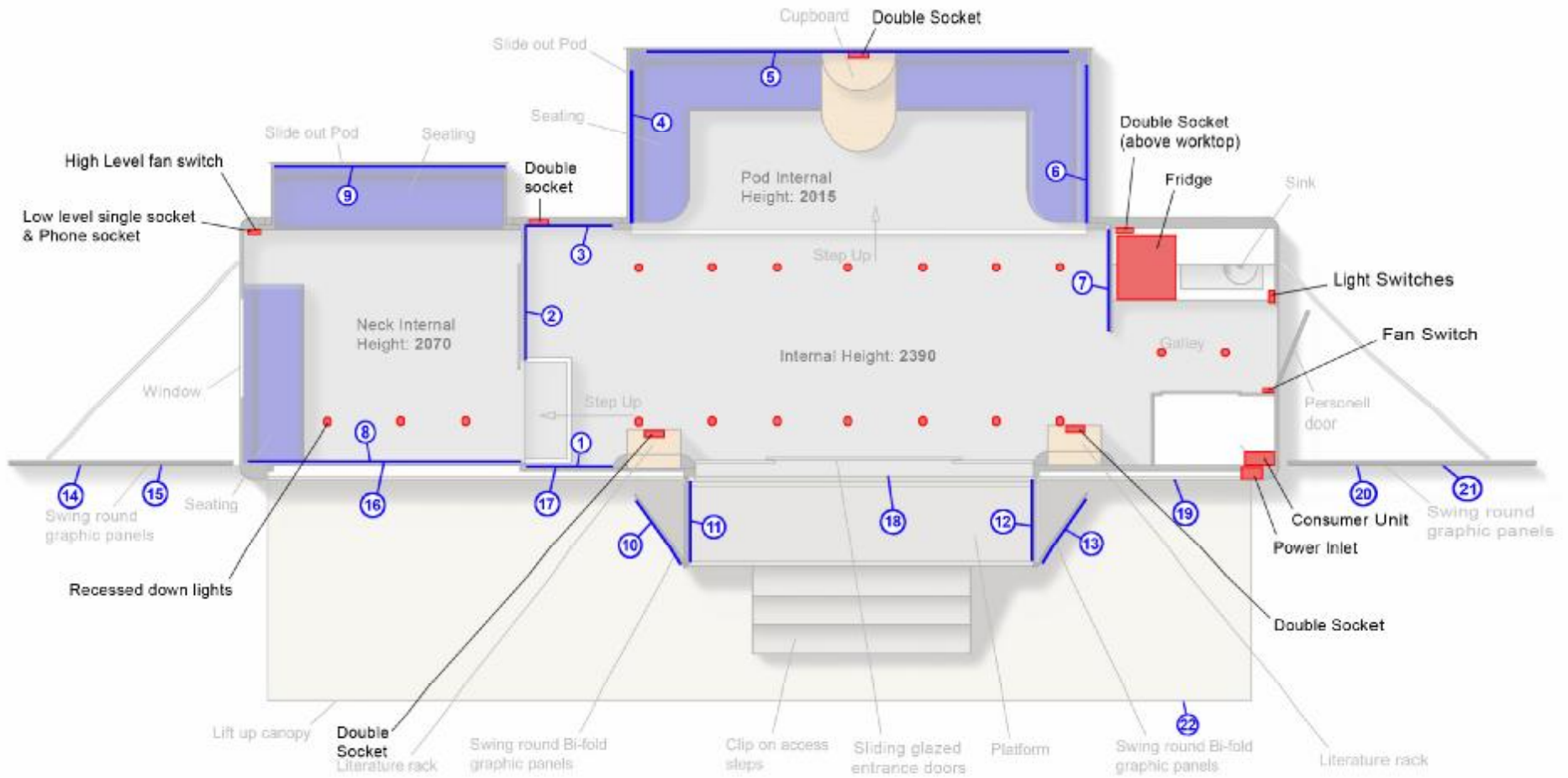

Interior Nyloop Graphic Panels (mm)

1) 700(w) x 1580(h)	6) 1260(w) x 1030(h)
2) 1140(w) x 1450(h)	7) 900(w) x 1450(h)
3) 720(w) x 1450(h)	8) 2380(w) x 1580(h)
4) 1250(w) x 1080(h)	9) 1980(w) x 1025(h)
5) 3600(w) x 1080(h)	

Bi-Fold Door Nyloop Graphic Panels (mm)

10) 665(w) x 1924(h)
11) 680(w) x 1924(h)
12) 680(w) x 1924(h)
13) 680(w) x 1924(h)

Exterior Graphic Areas:

14) 1925(w) x 1925(h)	19) 1560(w) x 1775(h)
15) 1925(w) x 925(h)	20) 1925(w) x 1925(h)
16) 2160(w) x 1820(h)	21) 1926(w) x 925(h)
17) 1300(w) x 1775(h)	22) Slide in Foamex panel: 8310(w) x 326(h) x 3
18) 2990(w) x 323(h)	or Vinyl graphic area: 8290(w) x 300(h)

DWT H55- 9m Hospitality Trailer

Nearside Graphic Area Elevation

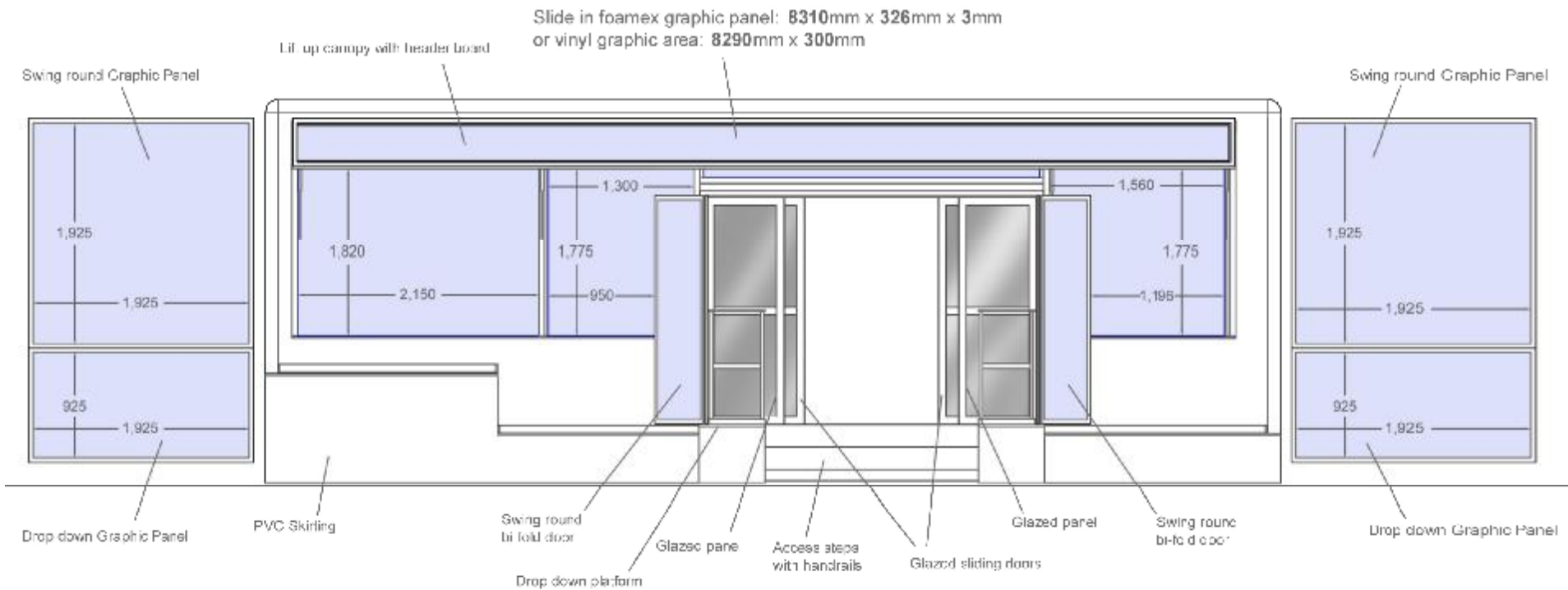

DWT Head Office Location Map



David Wilson's Trailers Ltd
 Jubilee Park,
 Honey Pot Lane,
 Colsterworth,
 Lincolnshire
 NG33 5LZ

tel: **+44 (0)1476 860 833**
 email: info@dwt-exhibitions.co.uk
 web: www.dwt-exhibitions.co.uk

